

Mini Mist Nozzles Internal Mixing Type

► Features

- Flow rate controllable within a wide range, from very small to relatively large.
- Compact and lightweight nozzles for connection in a limited space.
- Sprayed mist spreading over a large area due to a wide spray pattern.
- Quick-drying mist.
- Simple structure for resistance to clogging and for overhaul cleaning with ease.

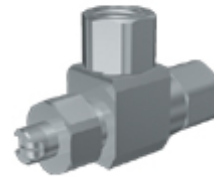

► Applications

- Flower cultivation, fountains, cooling of gases, spraying of chemicals, deodorization, humidification, etc.

► Material

- Stainless steel (standard material: SUS303) or brass

► Model

Connecting threads	1/8"
Flow rate	0.04 □ 0.3 L/min (at 0.3MPa)
Spray angle	-

Performance Data

Characteristic curves

Nozzle model number KSMMS 027115-A15W05

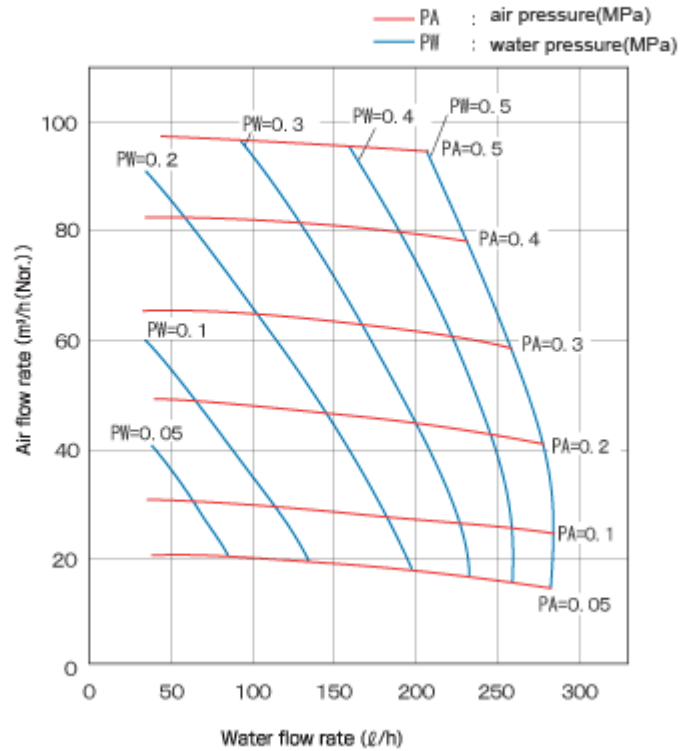

Spray patterns

Nozzle model number KSMMS 027115-A15W05

(Widthwise, view from top)

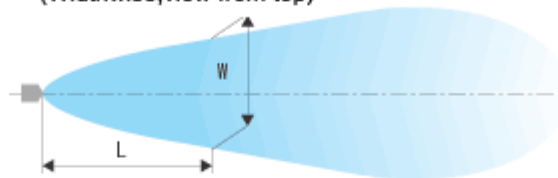

(Thicknesswise, view from side)



Air pressure (MPa)	Water pressure (MPa)	Air flow rate (ℓ/min) (Nor.)	Water flow rate (ℓ/min)	Air-water volume ratio	Spray pattern value(mm)		
					D	L	W
0.2	0.1	49	64	766	2500	500	450
						1000	600
						2000	700
0.3	0.2	65	102	637	3000	500	700
						1000	1000
						2000	1300

Example of particle diameter-air-water volume ratio graph

Nozzle model number: KSMMS 027115-A 15W 04
 Water flow rate: 50 ℓ/min

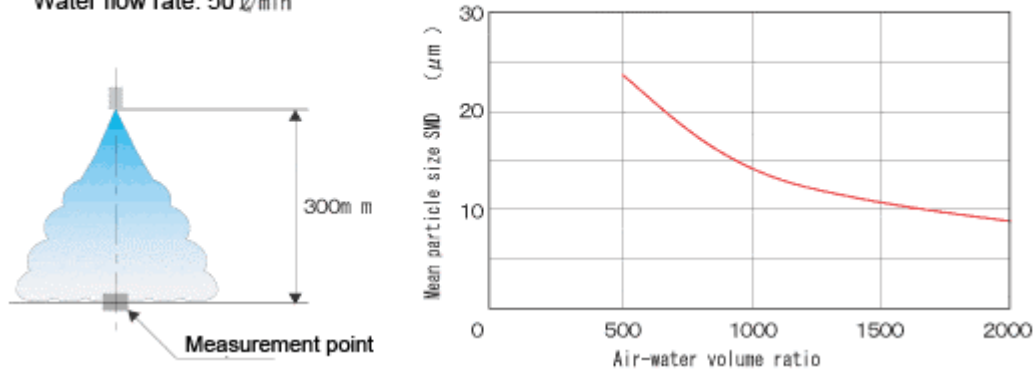

Example of particle diameter and velocity distribution graph

Nozzle model number KSMMS 027115-A15W05
 air flow rate 75ℓ /min (Nor.)
 water flow rate 50m ℓ/min
 air-water volume ratio 1500

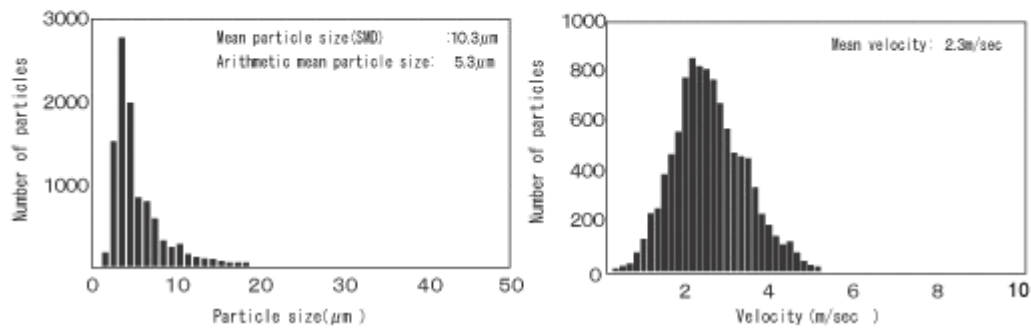

Shapes and dimensions

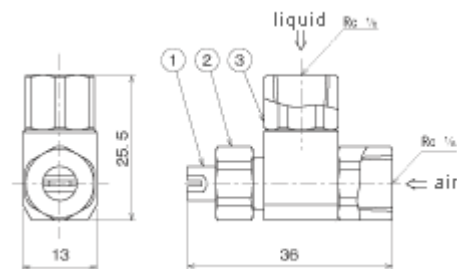

NPT thread is also available.

No.	Part Name
1	Nozzle tip
2	Cap
3	Mixing body

Weight(g)	35
-----------	----

